

11. Aanwinstentuin

- A *Thuja plicata* 'Martin'
- B *Fagus sylvatica*
- C *Prunus maackii*
- D *Aristolochia macrophylla*
- E *Akebia quinata*
- F *Geranium cantabrigiense* 'Biokovo'
- G Bloemenweide met o.a. cultivars van *Geranium sylvaticum*, *Geranium maculatum* en *Geranium phaeum*
- H *Pennisetum alopecuroides* f. *viridescens*

Een uitwerking van de beplanting in de vakken 1 t/m 7 vindt u hieronder.

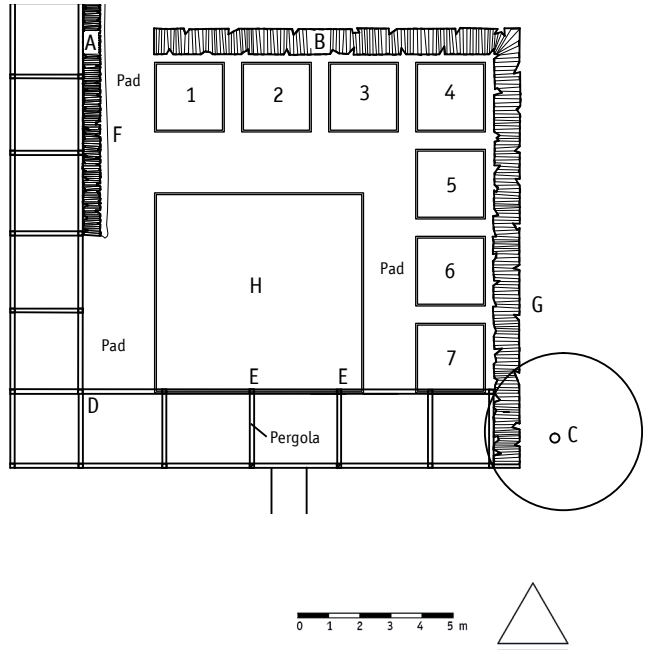

Vak 1, zon

1. *Eragrostis spectabilis*
2. *Kalimeris mongolica* 'Antonia'
3. *Nepeta* 'Veluws Blauwtje'
4. *Amorpha canescens*

Vak 2, zon

1. *Astilbe* 'Spotlight'
2. *Verbena* 'Purple Haze'
3. *Salvia nemerosa* 'Blue Bouquetta'
4. *Aster tataricus* 'Jindai'
5. *Molinia* 'Edith Dudzus'
6. *Geranium* 'Dreamland'
7. *Veronicastrum virginicum* 'Cupid'
Allium sphaerocephalon

Vak 3, zon

1. *Veronicastrum virginicum* 'Red Arrows'
2. *Monarda* 'Prairienacht'
3. *Geranium wallichianum* 'Silvery Blue'
4. *Salvia verticillata* 'Hannay's Blue'
5. *Echinacea* 'Magnus'
- A. *Panicum virgatum* 'Heavy Metal'
- B. *Dierama pulcherrimum*

Vak 4, zon

1. *Sporobolus heterolepis*
2. *Kniphofia* 'Alcazar'
3. *Scabiosa ochroleuca* 'Moon Dance'
4. *Achillea* 'Credo'
5. *Rudbeckia subtomentosa* 'Little Henry'
6. *Calamagrostis* 'Mona'
7. *Helenium* 'Little Orange'

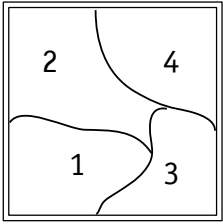

1

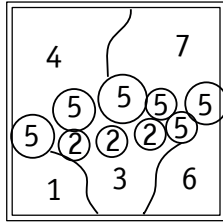

2

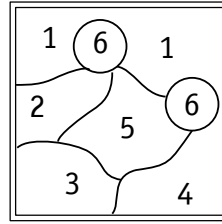

3

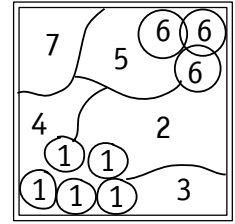

4

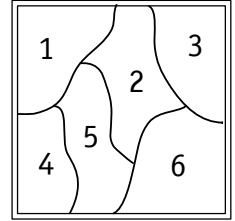

5

Vak 5, zon

1. Geum 'Totally Tangerine'
2. Helenium 'Loysder Wieck'
3. Sanguisorba 'Lum'
4. Pennisetum messiacum 'Red Bunny Tails'
5. Crocosmia masoniorum
6. Monarda 'Danish Dark'

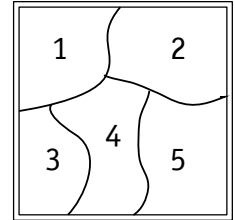

6

Vak 6, zon-halfschaduw

1. Carex flacca 'Blue Zinger'
2. Anemone 'Hadspen Abundance'
3. Pulmonaria 'Opal'
4. Lythrum virgatum 'Rose Queen'
5. Sanguisorba hakusanensis 'Lilac Squirrel'

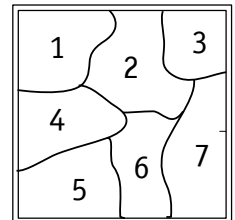

7

Vak 7, halfschaduw

1. Geranium 'Sabani Blue'
2. Isodon longitubus
3. Clematis heracleifolia 'Cassandra'
4. Aster ageratoides 'Eleven Purple'
5. Sanguisorba officinalis 'Pink Tanna'
6. Phlox paniculata 'Nachodka'
7. Actaea simplex 'Luftschlange'

